

# MODEL: FI-48W

Item # \_\_\_\_\_

## UNDERCOUNTER DISHWASHER

*Clear ideas; brilliant results.*

### Standard Features

- Heavy duty stainless steel construction, Type 304
- Auto-fill
- Built-in detergent pump
- Built-in drain pump
- Automatic drain valve to prevent overflow
- Built-in electric booster heater
- Utilizes fresh hot water rinse
- Electric tank heater
- Low water tank heat protection
- Hi-limit thermostat
- Built-in rinse aid dispenser
- Standard 20" x 20" racks
- Door safety switch
- Built-in hot water assurance
- Fully automatic wash and rinse cycle with correct temperature indicators for consistent cleaning
- Removable front electrical panel for easy access to controls
- Vacuum breaker
- Stainless steel non-clogging individual wash and rinse arms
- Wash tank with filter and tray system
- Adjustable legs
- Electrical cord, drain hose and fill hose supplied for quick and easy installation
- Standard with:
  - (1) CT-10 All purpose rack
  - (1) CP-16/18 Peg rack
  - (4) Cutlery containers

### Options and Accessories

- CT-10 All purpose rack
- CU-20 Cutlery grid
- CP-16/18 Peg rack
- Stand
- Cutlery containers



### PERFORMANCE / CAPACITIES

#### Capacities

Racks per hour	30
Dishes per hour	750
Glasses / cups per hour	1080
Wash Tank	6.6 gal. / 24.9 litre

#### Water Consumption / Requirements

Gallons per hr. (Max. use)	27 gal. / 102 litre
Gallons per cycles	.9 gal. / 3.40 litre
Inlet temperature (Optimum)	140°F / 60°C
Flow rinse pressure	15 – 25 PSI

#### Wash Pump Motor

Motor (hp)	1 hp
------------	------

#### Temperatures

Wash	150° F / 66° C
Rinse	190° F / 88° C

#### Heating

Electric wash tank heater	2.8 kw
Electric booster heater	2.8 kw

#### Operating Cycles

Wash time (seconds)	2 setting (100, 160)
Dwell (seconds)	5
Rinse time (seconds)	15
Total Time (seconds)	2 setting (120, 180)

#### Dimensions / Shipping

Width	24 1/4" / 616 mm
Depth	27 1/2" / 698 mm
Height	38 1/2" / 978 mm
Max. clearance for dishes / glasses	12 1/2" / 318 mm
Shipping weight	160 lbs / 73 kg
Shipping volume (cu. ft.)	15

**FAGOR**



Fagor Commercial, Inc.

6992 N.W. 82nd Avenue • Miami, Florida 33166  
 PH.: (305) 779-0170 • FAX: (305) 779-0173  
 Toll Free: 866-GO FAGOR (463-2467)

www.fagorcommercial.com



# MODEL: FI-48W

# UNDERCOUNTER DISHWASHER

## SPECIFICATIONS

**Construction:** The FI-48W is a fully automatic dishwasher completely constructed of high-quality stainless steel, type 304. Both upper and lower wash and rise arms are constructed of stainless steel to ensure a long life span.

**Controls:** Controls are top mounted and accessible for service from the front. Two preset time settings (120 and 180 second) for medium and heavy loads will optimize energy and time.

**Filling and heating system:** The power-on switch automatically fills the tanks to the proper level. Wash tank water temperature is maintained by a 2.8 kw element. Built-in 2.8 kw electric booster heater. Safety thermostats and a pressure switch protect heating elements in case of low water or fail.

**Hot Water Assurance:** The FI-48W guarantees that the minimum sanitizing temperature of 180 °F during the final rinse is achieved regardless of the incoming water temperature. Machine will continue washing up to the rinsing temperature is reached. The rack capacity and cycle time will vary depending on incoming water temperature, voltage of dishmachine and water pressure.

**Drainage:** Filter system with removable scrap basket, prevents waste from getting into the washing pumps. Drain pump with built-in dismountable filter, located in the front, for easy cleaning. Automatic drainage to prevent overflow.

## SERVICE CONNECTIONS

**A** – Water inlet – 3/4" Female hose connector on 5' long flexible hose supplied with machine; Adaptor for 3/4" female garden hose fitting also supplied; 140°F / 60°C Optimum water temperature; 15-25 psi flow rinse pressure.

**D** – Drain – 5' long, 1/2" I.D. flexible hose; Maximum 31 1/2" drain height permitted; Indirect connection to drain pipe.

**R** – Electrical terminal block connection point.

**E** – Electric power supply - 6' long electrical cord supplied with machine

## ELECTRICAL AND PRODUCTION LOADS

Volts/Hz/Ph	Amps
208/60/1	15
220/60/1	16
240/60/1	17

\*50 Hz models, consult factory

Incoming Water Temp	140°F	110°F	80°F
Aprox. racks per hour	30	20	14

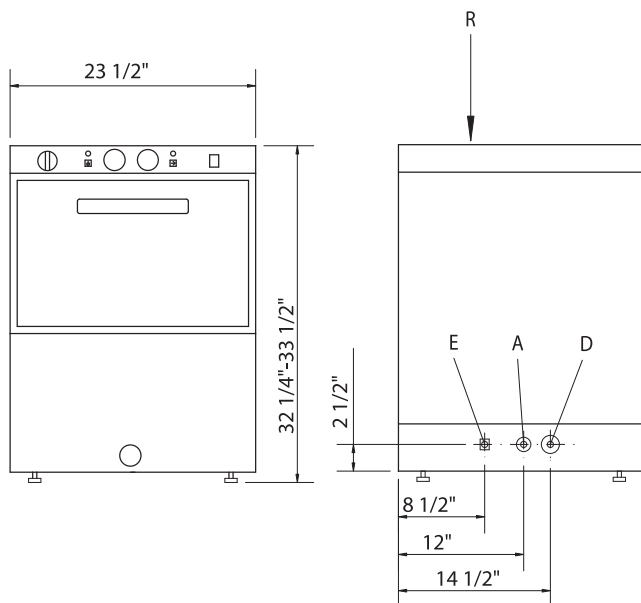

Front View

Back View

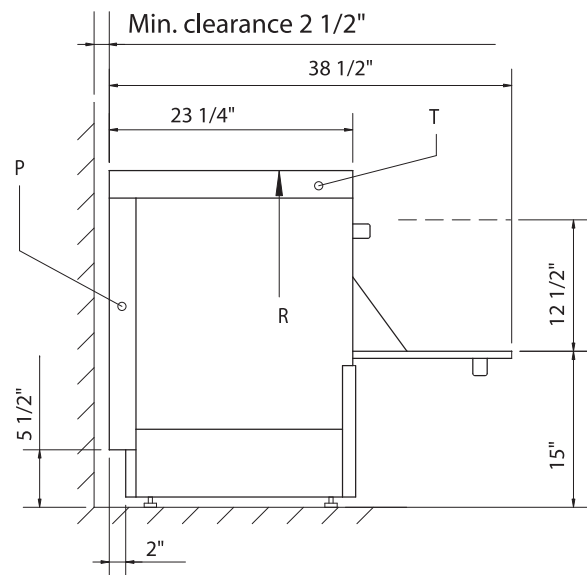

Side View

**Caution** - Before connecting water to this unit, have water supply analyzed to make sure hardness is not greater than 2.0 grains and pH level is within the range of 7.0-8.5. Water which fails to meet these standards, should be treated by the installation of a water conditioner. EQUIPMENT FAILURE CAUSE BY INADEQUATE WATER QUALITY IS NOT COVERED UNDER WARRANTY.

**Warning** - Installation should be made by qualified personnel who will observe all specified local codes.



Fagor Commercial, Inc.

6992 N.W. 82nd Avenue • Miami, Florida 33166  
PH.: (305) 779-0170 • FAX: (305) 779-0173  
866-GO FAGOR (463-2467)

www.fagorcommercial.com

The manufacturer reserves the rights to modify materials and specifications without notice.  
Printed in the USA • 09/04